

# SPARE PARTS

## G75-0 | AC/DC Operator 2 Way, 3 Way NC, NO



2W Operator

3W Operator

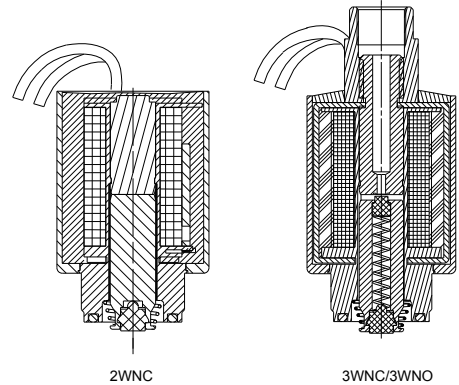

2WNC

3WNC/3WNO

### Technical Data

Function	2 Way, 3 Way NC, NO
Orifice size	2 Way : No orifice 3 Way : See table
Pressure range (bars)	See solenoid valve performances
Temperature range	<b>Fluid</b> : 5°C to 50°C   <b>Ambient</b> : -10°C to 50°C
Materials in contact with media	<b>Housing:</b> Reinforced Nylon 66 <b>Plunger &amp; pole:</b> Passivated Stainless Steel AISI 430F <b>Rubber Seals:</b> EPDM <b>Encapsulate:</b> Polyurethane <b>Spring:</b> Stainless Steel AISI 300 series
Media	Air, water, oil *
Threads on operator tube	G1/8" or 1/8" NPT female to connect exhaust, muffler etc
Operator assembly	By manually screwing 3/4" UNEF to valve body. • <b>Max. tightening torque : 2 N/m</b>
Electrical connection	Lead wires 35 cm, 18 AWG (0.75mm <sup>2</sup> ) * <b>other lengths are available</b>
Coil voltage	• Voltage and power consumption - see table
Standard protection class	IP66

- Available with brass adaptor upon request.
- \* For other fluids and for use in abnormal conditions, please contact our technical sales department

### Working pressure (bar) 2W NC

Orifice (mm)	up to 2.0
Pressure (bar)	12

### Working pressure (bar) 3W NC

Orifice (mm)	1.0	1.2	1.6
AC Pressure (bar)	16	11	6
DC Pressure (bar)	12	9	5

### Working pressure (bar) 3W NO

Orifice (mm)	1.0	1.2	1.6
Pressure (bar)	16	12	8

### Voltage & Current table

Solenoid	Voltage	Inrush [A]	Holding [A]
2W 50 Hz	V +10% n-20%	0.3	0.19
2W 60 Hz		0.2	0.14
3W 50/60 Hz		0.125	0.125
DC		4.5W	

### Voltage & Power Consumption

	AC (W)	DC (W)
V	2	4.5
12	•	•
24	•	•
110	• 2W only	

- Available options

# G75-0 | AC/DC Operator 2 Way, 3 Way NC, NO

## Dimensions

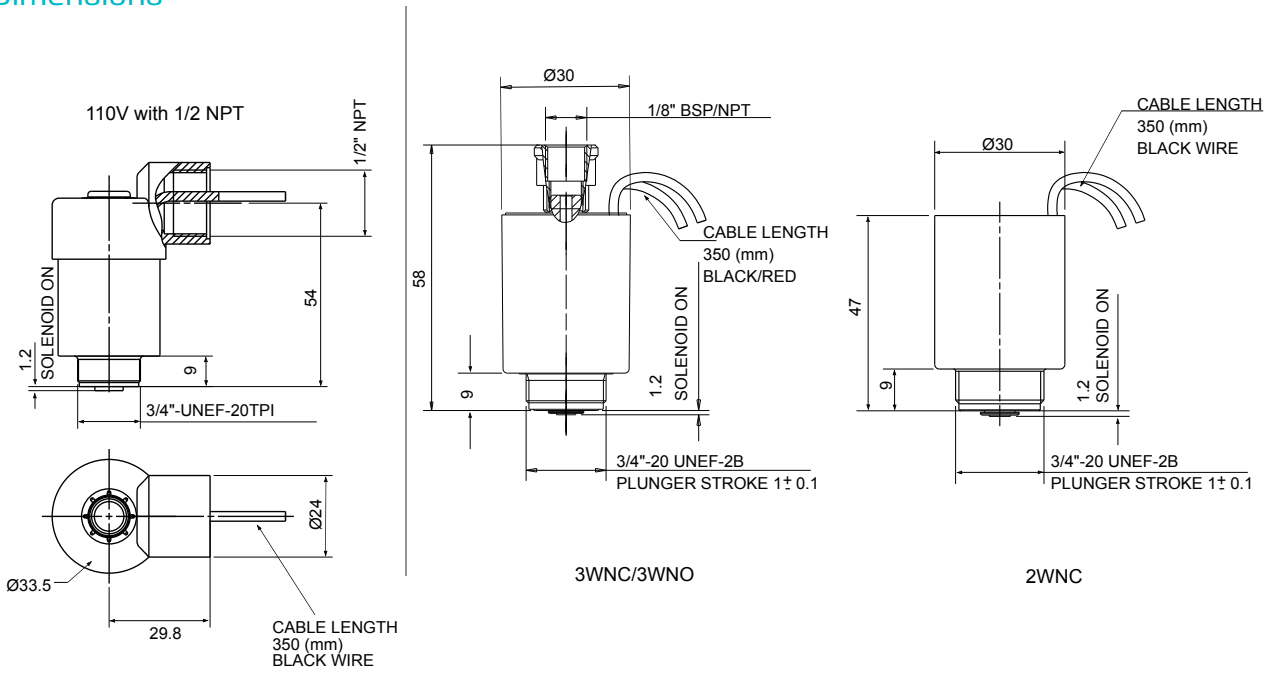

## How to Order

### 2W

G75-0	-	FUNCTION	VOLTAGE	
		2W NC	1	

  

G75-0	-	PORT	FUNCTION	ORIFICE	VOLTAGE			
		1/8" BSP	10	3W NC	3	1.0	1	
		1/8" NPT	11	3W NO	4	1.2	2	
						1.6	3	
							24V AC	1
							24V AC w/out Diode	1R
							12V AC	3
							12V DC	4
							24V DC	5
							110V AC <sup>(1)</sup>	7

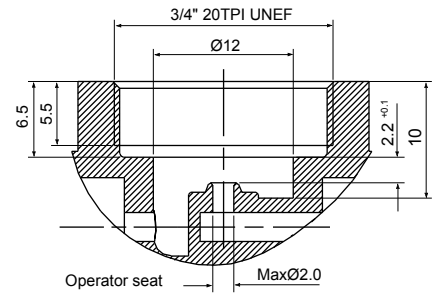

### Example : G75-0-1-1

G75 operator, 2W NC, 24V AC

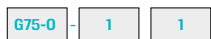

### Example : G75-0-1032-1

G75 operator, 1/8" BSP, 3W NC, DC, 1.2 orifice, NBR, 24V AC



(1) 110V AC - available in 2 Way only

\* To order operators manufactured according to your specific requirements, please contact our technical sales department.